

POWER
 IN: 24VDC, 180mA
 OUT: N/A

(4) RELAY OUTPUTS (RO), (4) LOAD STATUSES
LOAD RATINGS: Magnetic Bal. 20A at 277 VAC
 Electronic Bal. 16A at 277 VAC
 Tungsten 20A at 277 VAC
 Resistive 20A at 277 VAC

WIRE: 14-10 AWG Solid or Stranded, Copper

DIMENSIONS
 3.5" H x 3.5" W

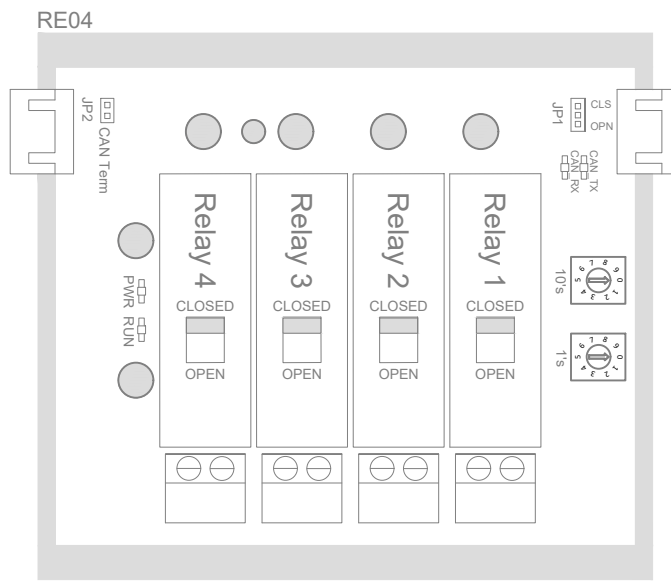

POWER
 IN: 24VDC, 180mA
 OUT: N/A

(4) RELAY OUTPUTS, (RO) (4) LOAD STATUSES
LOAD RATINGS: Magnetic Bal. 20A at 277 VAC
 Electronic Bal. 16A at 277 VAC
 Tungsten 20A at 277 VAC
 Resistive 20A at 277 VAC

WIRE: 14-10 AWG Solid or Stranded, Copper

UL924 JUMPER (JP1)
 (Emergency Disabled) (Emergency Action - Close) (Emergency Action - Open)

DIMENSIONS
 3.5" H x 3.5" W

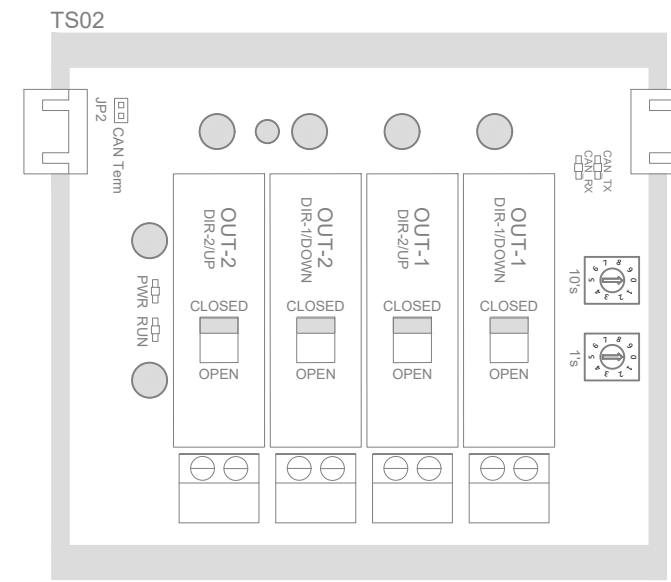

POWER
 IN: 24VDC, 180mA
 OUT: N/A

(2) TRI-STATE OUTPUTS (TS)
LOAD RATINGS: Magnetic Bal. 20A at 277 VAC
 Electronic Bal. 16A at 277 VAC
 Tungsten 20A at 277 VAC
 Resistive 20A at 277 VAC

WIRE: 14-10 AWG Solid or Stranded, Copper

DIMENSIONS
 3.5" H x 3.5" W

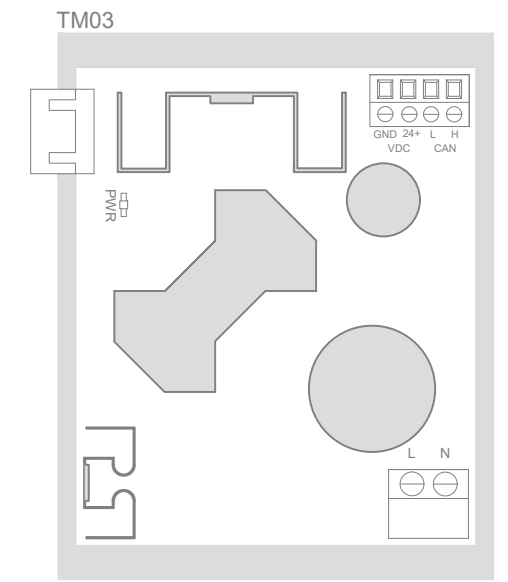

POWER
 IN: 120-277 VAC, 50/60HZ, +/-10%
 Single Phase 20A Circuit
 OUT: 24 VDC, 2.5A Max

DIMENSIONS
 3.5" H x 2.5" W

CABLE:
 SEE GENERAL

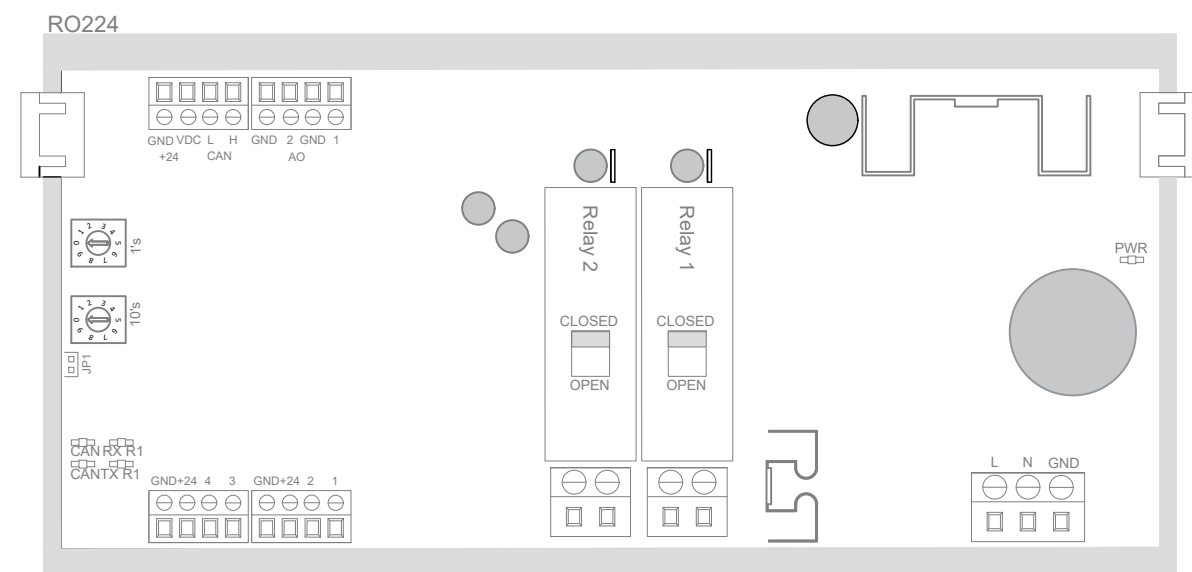

POWER
 IN: 120-277 VAC, 50/60HZ, +/-10%
 Single Phase 20A Circuit
 OUT: 24 VDC, 2500mA Max

(2) RELAY OUTPUTS, (RO) (2) LOAD STATUSES
LOAD RATINGS: Magnetic Bal. 20A at 277 VAC
 Electronic Bal. 16A at 277 VAC
 Tungsten 20A at 277 VAC
 Resistive 20A at 277 VAC

WIRE: 14-10 AWG Solid or Stranded, Copper

DIMENSIONS
 3.5" H x 6.5" W

(2) ANALOG OUTPUTS (AO)
 POWER: 0-10 VDC, Sink 100mA or Source 5mA Each
 WIRE: CL3P-18/2, 1000' Max

(4) UNIVERSAL INPUTS (UI) (2) LOAD STATUSES
 GENERAL CABLE: CL3P-22/2, 1000' Max
 SENSOR CABLE: CL3P-18/3, 1000' Max

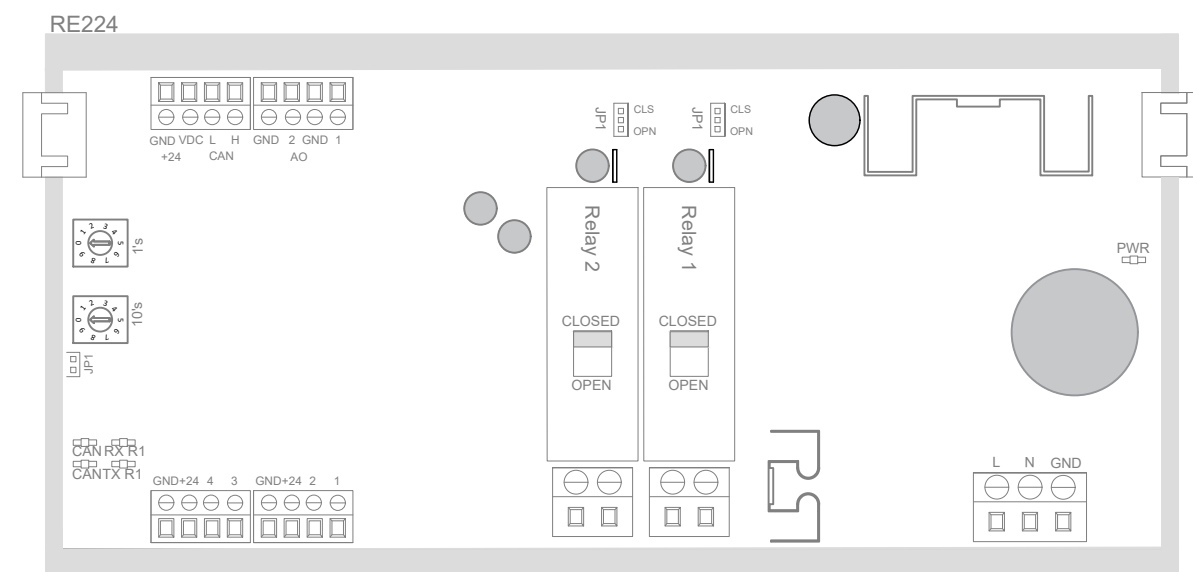

POWER
 IN: 120-277 VAC, 50/60HZ, +/-10%
 Single Phase 20A Circuit
 OUT: 24 VDC, 2500mA Max

(2) RELAY OUTPUTS (RO), (2) LOAD STATUSES
LOAD RATINGS: Magnetic Bal. 20A at 277 VAC
 Electronic Bal. 16A at 277 VAC
 Tungsten 20A at 277 VAC
 Resistive 20A at 277 VAC

WIRE: 14-10 AWG Solid or Stranded, Copper

DIMENSIONS
 3.5" H x 6.5" W

UL924 JUMPER (JP1)
 (Emergency Disabled) (Emergency Action - Close) (Emergency Action - Open)

(2) ANALOG OUTPUTS (AO)
 POWER: 0-10 VDC, Sink 100mA or Source 5mA Each
 WIRE: CL3P-18/2, 1000' Max

(4) UNIVERSAL INPUTS (UI)
 GENERAL CABLE: CL3P-22/2, 1000' Max
 SENSOR CABLE: CL3P-18/3, 1000' Max

GENERAL

CANbus NETWORK
 TOPOLOGY: Daisy Chain
 COMM WIRE: CL3P-22/2-LC, Max 1000'
 POWER WIRE: CL3P-22/2, Max 1000'

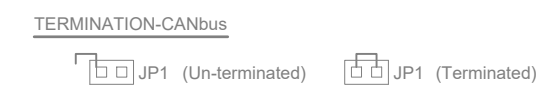

Engineering Standards CLIDTL_01.21			
<i>Class I Module Detail, Standards</i>			
Rev: 01.21	Type: Detail Drawing	Date: 05/24/2022	Job #:
BLUE RIDGE TECHNOLOGIES™ UNIFIED LIGHTING CONTROL			Engineered: WCD
			Drawn: EFM
			Checked: WCD
			Page: 1 of 1