

Tech Note 040220_01

Date: April 2, 2020
Product: TK-3.0
Subject: Bluetooth Pairing Procedure

Computer Requirements

- Operating System: Windows 7 (32/64-bit) or Windows 10 (32/64-bit)
- USB: Standard-A USB 2.0 port
- Bluetooth: Microsoft Bluetooth Stack Enabled

*Prior to pairing, ensure Bluetooth receiver is correctly installed and Controller is powered.



1. Click the **Start** Button, then **Settings**.
2. Click **Devices**.
3. Check that your Bluetooth is on, then **Add Bluetooth or other device**.
4. Click **Bluetooth**.
5. Select appropriate device. (The device name is located on the top of the Bluetooth Module)

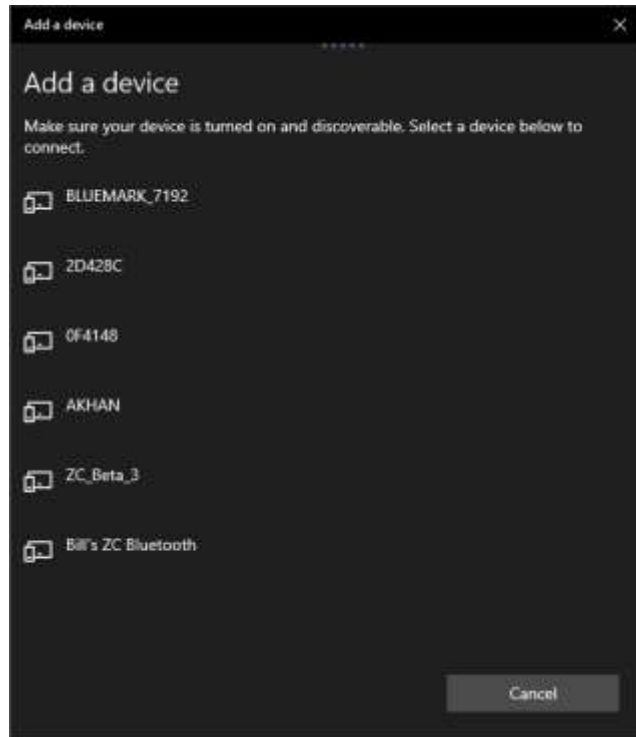

6. Enter the pairing code (1234) then click **Connect**.

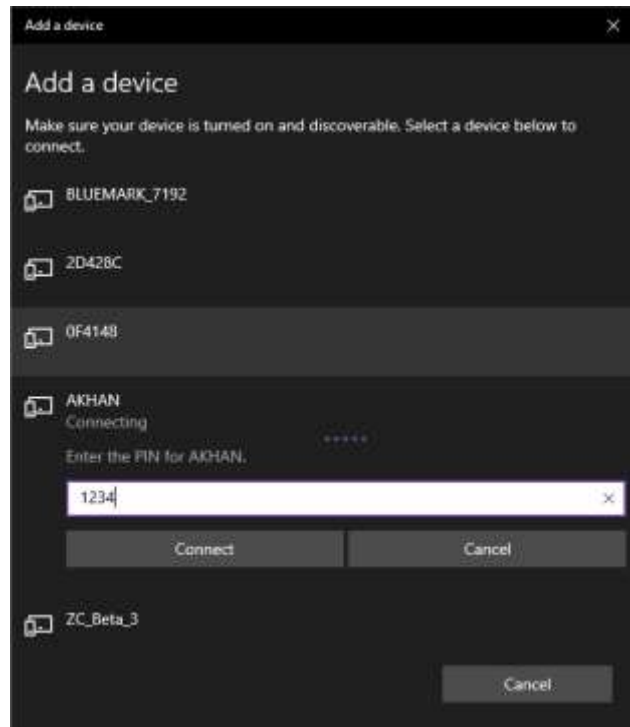

7. The device is ready to use. Click **Done** to finish.

